

Orange Coast Chemical/Janitorial Supply

714 531 3570



Find Your Cleaning Solution(s) Here!

orangecoastchem@gmail.com

Chemicals / Janitorial / Paper
Carpet Cleaning / Equipments

8573 Garden Grove Blvd, Garden Grove, CA 92844

Fax 714 534 6721



Sanitaire Vacuum Parts

Motor Assembly Parts

- | | |
|--------------------------------------|-----------|
| A. Complete Motor Assembly | P808 |
| B. Motor Base Assembly | P808base |
| C. Motor Cover | P808cover |
| D. Carbon Brush | P875 |
| E. Carbon Brush 33474 w Brass holder | P33474 |

Base Assembly Parts

- | | |
|--------------------------------|--------|
| F. Rug Bottom Plate 12" Chrome | P1822 |
| G. Rug Bottom Plate 16" Chrome | P1824 |
| H. Fan Chamber Cover | P822 |
| I. Base 12" Quick Kleen | P829 |
| J. Base 16" Quick Kleen | P21874 |



Complete Motor Assembly
P808

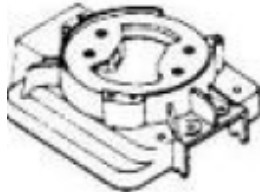

Motor Cover
P808cover



Rug Bottom Plate
P1822: 12"
P1824: 16"



Motor Base Assembly
P808base



Motor Carbon Brush
P875: left
P33474: Right



Fan Chamber Cover
P21874

Phone 714 531 3570

Email: orangecoastchem@gmail.com



Sanitaire Vacuum Parts

Base Assembly Parts

A. Base 12" Quick Kleen	P829
B. Base 16" Quick Kleen	P21874
C. Bumper 12" Quick Kleen	P1806
D. Bumper 16" Quick Kleen	P1807
E. Hook Cover Plastic	P21812
F. Hook Cover Chrome	P21811
G. Vacuum Magnet 12"	J1232
H. Vacuum Magnet 16"	J1230
I. Height Adjustment Knot 6 Way	P802
J. Screw Knot	P800



Complete Motor
Assembly

P829: 12"
P21874: 16"

P1806: 12"
P1807 16"



Hook Cover Plastic
P21812

Hook Cover Chrome
P21811



Vacuum Magnet
J1232: 12"
J1230: 16"



Bumper



Knot 6 Way
P802: Knot

Phone 714 531 3570

Email: orangecoastchem@gmail.com

P800: Screw



Sanitaire Vacuum Parts

Brush Parts

- | | |
|---------------------------------|-----------|
| A. Brush Roll VG2 12" | P21856 |
| B. Brush Roll VG2 16" | P21853 |
| C. Brush Roll VG2 16" old Style | P21853old |
| D. Brush Roll VG1 12" | P21850 |
| E. Brush Roll VG1 16" | P21847 |
| F. Brush Strip VG2 12" | P21814 |
| G. Brush Strip VG2 16" | P21813 |
| H. Brush Strip VG1 12" | P1893 |
| I. Brush Strip VG1 16" | P1863 |



Brush Roll VG2 12":
P21856
Brush Roll VG2 16":
P21853



Brush Roll VG1 12":
P21850
Brush Roll VG1 16":
P21847



Brush Strip VG2 16":
P21813



Brush Roll VG2 16"
Old Style:
P21853old



Brush Strip VG2 12":
P21814



Brush Strip VG1
P1893: 12"
P1863: 16"



Sanitaire Vacuum Parts

Brush Parts

A. Brush Roll 54325-1	P54325
B. Brush Roll 60252-2	P60252
C. Shaft Brush Roll VG2 12"	P21834
D. Shaft Brush Roll VG2 16"	P21815
E. Beater Bar Brush Roll VG1 Long	P1871
F. Beater Bar Brush Roll VG1 short	P1886
G. Brush Rubber End Adapter	P21809
H. VG1 End Cap -Square	P35662
I. VG1 End Cap 26057A	P1862
J. VG1 End Cap 26058	P26058
K. Felt Washer Brush Roll	P49899



Brush Roll 54325-1
P54325



Shaft Brush Roll VG2
16"
P21834: 12"
P21815: 16"

P1871: Long
P1886: Short



Brush End Parts
P21809: End Adapter
P49899: Felt Washer



Brush Roll 60252-2
P60252



Beater Bar Brush Roll
VG1 Long



VG1 End Cap

P35662: E35662 square

Phone 714 531 3570

Email: orangecoastchem@gmail.com

P1862: E26057A

P26058: E26058



Sanitaire Vacuum Parts

Handle Parts

- | | |
|-------------------------------------|--------|
| A. Upper Handle with White Grip | P869 |
| B. Lower Handle | P870 |
| C. Handle Release Spring | P814 |
| D. Handle release Lever | P812 |
| E. Handle Socket | P860 |
| F. Handle Socket with Spring inside | P860S |
| G. Handle Socket Shield | P857 |
| H. Bolt & Nut for Handle to Base | P856 |
| I. Handle Socket Bolt | P53145 |
| J. Handle Socket Nut | P53213 |
| K. Upper Hook | P853 |
| L. Lower Hook | P855 |



Upper Handle with White Grip
P869
Lower Handle
P870

P814
Handle release Lever
P812



Handle Socket
P860: Standard
P860S Spring Inside



Bolt & Nut for Handle to Base
P856
P53145: Handle Screw
P53213: Handle Nut



Brush Roll 60252-2

Handle Socket Shield
P857



P853: Upper Hook
P855: Lower Hook

Phone 714 531 3570

Email: orangecoastchem@gmail.com



Sanitaire Vacuum Parts

Cloth Bag & Electric Cord Parts

A. Cloth Bag	J1225
B. Cloth Bag Spring Only	P1853S
C. Cloth Bag Clip	P1853
D. Cloth Bag Adapter Ring	P18151
E. Electric Cord 50'	P858
F. Electric Cord Strain Relief	P824
G. Cord Spring	P862
H. Switch Push	P871
I. Switch Step On	P825
J. Switch Button	P886



J1225: Cloth Bag
P18151: Adpater Ring



P858: Electric Cord 50'
P824: Electric Cord Strain Relief



P871: Switch Push
P825: Switch Step On



P1853: Cloth Bag Clip
P1853S: Cloth Bag Spring



Cord Spring
P862



Switch Button
P886

Phone 714 531 3570

Email: orangecoastchem@gmail.com



Sanitaire Vacuum Parts

Bottom Parts

- A. Vacuum Fan
- B. Vacuum Fan Black
- C. Fan Felt Washer Spacer
- D. Fan Washer Metal
- E. Belt Pulley Long
- F. Belt Pulley Short
- G. Belt
- H. Hook Spring
- I. Bumper Clip
- J. Scroll Cover Gasket

- P883
- P894
- P881
- P21844
- P885
- P888
- J1220
- P818
- P21864
- P810

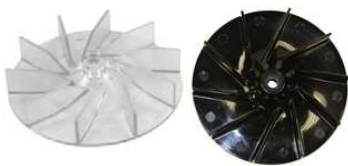

P883: Vac Fan Clear
P894: Vac Fan Black



P885: Belt Pulley Long
P888: Belt Pulley Short

P818: Hook Spring

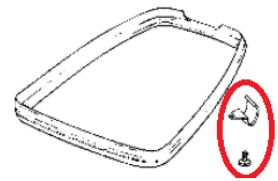

Bumper Clip
P21864:



P881: Felt Washer Fan
P21844: Metal Washer

Electric Cord Strain Relief



J1220: Belt- Brush Roll



Scroll Cover Gasket
P810



Sanitaire Vacuum Parts

Wheel Axle Parts

A. Rear Axle Cap	P1811
B. Rear Axle	P1826
C. Axle Clamp	P1812
D. Clamp & Screw Assembly	P53140
E. Rear Wheel Quickeen	P1828
F. Rear Wheel old Style	P1827
G. Front Wheel	P1830
H. Light Bulb	P21870
I. VB2 Brush Retain Bearing	P54256
J. Lower Motor Bearing Retainer	P892



P1811: Rear Axle Cap
P1826: Rear Axle



P1828: Rear Wheel
P1827: Rear Wheel
Old Style



VB2 Brush Retain Bearing
P54256



P1812: Axle Clamp
P53140: Clamp Screw
Assembly

Electric Cord Strain Relief



P1830: Front Wheel
P21870: Light Bulb



Lower Motor
Bearing Retainer
Switch Button
P892



II Vacuum Bags Cloth & Backpack

Cloth Vacuum Bags

- | | |
|--------------------------------------|--------|
| A. Sanitaire Shake-out Red | J1225 |
| B. Sanitaire Zip Red (Special Order) | J1225Z |
| C. Koblenze Black | J1236 |

BackPack Paper Vacuum Bags

- | | |
|------------------------------------|------|
| D. Back pack 10 qt | VB4 |
| E. Back pack 10 qt Proteam Genuine | VB4G |

Special Paper Vac Bags

- | | |
|-------------------------|-------|
| F. Style '7" Bissell | J1199 |
| G. Hawk | J1997 |
| H. Windsor 2003 Genuine | J1998 |



J1225: Cloth Shake-out
J1225Z: Cloth Zip
J1236: Koblenze Black



VB4: 10 qt backpack Bag
VB4G: Proteam Genuine



J1997: Hawk Vac Bag



J1199: Bissell style "7"



J1998: Windsor 2003 Genuine

Phone 714 531 3570

Email: orangecoastchem@gmail.com



Vacuum Bags Paper Bags

Paper Vacuum Bags

I. Type A Hoover / Bissell Style2 / Singer SUB-3 / HEMS-1 / Kenmore 5037 or 50378	J1215
J. Type C Eureka	J1214
K. Type C Panasonic	J1227
L. Type D Hoover	J1209
M. Type F & G Eureka Genuine	J1213B
N. Type F & G	J1213C
O. Type J Hoover	J1217
P. Type MM Eureka	J1212
Q. Type MM	VB2
R. Type N Eureka	J1219
S. Type N Hoover	J1216
T. Type S Eureka	J1211
U. Type U Panasonic	J1218
V. Type Z Eureka	J1270



Phone 714 531 3570

Email: orangecoastchem@gmail.com



Vacuum Belts

Vacuum Belts

- A. Sanitaire Round Belt
- B. Hoover Round 49258
- C. Hoover Elite Flat 38528033
- D. Hoover Flat 38528040
- E. Panasonic Flat 2/pk MC-V241B
- F. Eureka fits Bravo Victory Upright Vac
- G. Panasonic Flat UB8 MC-V270B
- H. H33 1/16" Flat Belt
- I. 3/32" Flat Belt

- J1220
- J1221
- J1222
- J1222A
- J1223
- P1263
- J1224
- P1264
- P1265



J1220: Sanitaire Round

Hoover Flat 385280033



J1222A:
Hoover Flat 38528040



P1263: Eureka Flat
Bravo/ Victory Upright Vac



J1221: Hoover Round 49258



J1223:
Panasonic MC-V241B



J1224:
Panasonic MC-V270B



J1222:

Phone 714 531 3570

Email: orangecoastchem@gmail.com



III Floor Pads Stripping / Scrub

Black Stripping

A. 14" Black	J1690
B. 15" Black	J1691
C. 16" Black	J1692
D. 17" Black	J1693
E. 18" Black	J1694
F. 19" Black	J1695
G. 20" Black	J1696
H. 22" Black	J1697
I. 19" Black Thin Americo	PAD400119

Green Scrub

J. 14" Green	J1698
K. 15" Green	J1699
L. 16" Green	J21600
M. 17" Green	J21601
N. 18" Green	J21602
O. 19" Green	J21603
P. 20" Green	J21604
Q. 22" Green	J21605





Floor Pads Spray / Polish

Red Spray

A. 12" Red	FP12R
B. 14" Red	J1649
C. 15" Red	J21607
D. 16" Red	J21608
E. 17" Red	J21609
F. 18" Red	J21610
G. 19" Red	FP19R
H. 20" Red	FP20R
I. 22" Red	FP22R

White Polish

J. 15" White	J21615
K. 16" White	J21616
L. 17" White	J21617
M. 18" White	J670
N. 19" White	FP19WHI
O. 20" White	J1620



Phone 714 531 3570

Email: orangecoastchem@gmail.com



Floor Pads

Burnishing

Gorilla = Porko Exterme Burnish

- | | |
|------------------------------|---------|
| A. 19" Gorilla | J21622 |
| B. 20" Porko Extreme Burnish | FP20PPE |

Gorilla Light = Combo Burnish

- | | |
|----------------------|---------|
| C. 19" Gorilla Light | J21628 |
| D. 19" Combo Burnish | FP19ACE |
| E. 20" Combo Burnish | FP20ACE |

Porko Plus = Jaguar (ETC)

- | | |
|-------------------|--------|
| F. 19" Porko Plus | FP19WB |
|-------------------|--------|

Porko Lite

- | | |
|-------------------|-------|
| G. 22" Porko Lite | J1618 |
|-------------------|-------|

Champagne Burnish

- | | |
|--------------------------|--------|
| H. 19" Champagne Burnish | J21631 |
| I. 20" Champagne Burnish | J21629 |

Image Beige Burnish

- | | |
|----------------------------|--------|
| J. 20" Image Beige Burnish | J21632 |
| K. 21" Image Beige Burnish | J21633 |
| L. 22" Image Beige Burnish | J1617 |

Aqua Burnish

- | | |
|---------------------|-------|
| M. 21" Aqua Burnish | J1670 |
|---------------------|-------|



IV Rotary Brush Malish

Pad Driver - PAD-LOK™

- A. 16" Pad Driver 5" Center Hole MB7827-16
- B. 19" Pad Driver 5" Center Hole MB7827-19

Carpet Brush Shampoo Poly

- C. 15" Poly Carpet Brush 0.020"/0.025" 5"CH MB8124-15
- D. 18" Poly Carpet Brush 0.020"/0.025" 5" CH MB8124-18

Carpet Brush Shampoo Nylon

- E. 15" Poly Carpet Brush 0.025"/0.028" 5" CH MB9-15
- F. 18" Poly Carpet Brush 0.025"/0.028" 5" CH MB9-18

Clutch & Riser

- G. Clutch Plate Black Plastic "92" "B" NP9200 J452BM
- H. Clutch Plate Plastic "47" "C" NP47 J452CP
- I. Riser Plastic 1.5" Plastic J457
- J. High Speed Riser J457-HS



MB7827-16: Pad Driver 16"
MB7827-19: Pad Driver 19"



MB8124-15: Poly Brush 15"
MB8124-18: Poly Brush 18"
MB9-15: Nylon Brush 15"
MB9-18: Nylon Brush 18"



J452BM: NP9200 Clutch
J452CP: NP47 Clutch



J457: Riser 1.5"



J457-HS: High Speed Riser



Rotary Brush

Pad Driver

- | | |
|--|-----------|
| A. 14" Pad Driver 5" Center Hole ½" Trim | J439-14 |
| B. 16" Pad Driver 5" Center Hole ½" Trim | J439-16 |
| C. 18" Pad Driver 5" Center Hole ½" Trim | J439-18 |
| D. 18" Pad Driver 5" Center Hole 1" Trim | J439-18T1 |
| E. 19" Pad Driver 5" Center Hole ½" Trim | J439-19 |
| F. 20" Pad Driver 5" Center Hole ½" Trim | J439-20 |

Brush Black Poly

- | | |
|--------------------------------|---------|
| G. 14" Poly Brush 0.022" 5"CH | J447-14 |
| H. 16" Poly Brush 0.022" 5" CH | J447-16 |
| I. 18" Poly Brush 0.022" 5" CH | J447-18 |
| J. 20" Poly Brush 0.022" 5" CH | J447-20 |

Brush Black Nylon

- | | |
|--------------------------------|----------|
| K. 15" Nylon Brush 0.02" 5" CH | KM143-15 |
|--------------------------------|----------|

Carpet Shampoo Brush

- | | |
|--|----------|
| L. 15" Stiff Poly Brush Blue 0.03" 5"CH | J447-15 |
| M. 17" Soft Poly Brush Yellow 0.02" 5"CH | KM142-17 |



- J439-14: Pad Driver 14"
- J439-16: Pad Driver 16"
- J439-18: Pad Driver 18"
- J439-18T1: PD 18 1" Trim
- J439-19: Pad Driver 19"
- J439-20: Pad Driver 20"



- J447-14: Poly Brush 14"
- J447-16: Poly Brush 16"
- J447-18: Poly Brush 18"
- J447-20: Poly Brush 20"
- KM143-15: Nylon Brush 15"



- J447-15: Blue Shampoo Poly 15"



- KM142-17: Yellow Shampoo Poly 17"

Phone 714 531 3570

Email: orangecoastchem@gmail.com



Rotary Brush

Brush Wood Block - Black

- A. 10" Brush Black 0.025 J447-10
- B. 13" Brush Black 0.022" J447-13
- C. 14" Brush Black 0.025" J447-14WD
- D. 17" Brush Black 0.028" J447-17WD
- E. 19" Brush Black 0.025" J447-19WD

Brush Wood Block - White

- F. 14" Brush Black 0.028" J447-14WHI

Brush Wood Block - Brown

- G. 13" Brush Brown 0.022" J447-13BR

Brush Wood Block Green

- H. 15" Brush Green 0.04" Brush15Green

Brush - Hand Tools

- I. 5.5" Brush White Soft Polish J447-5.5



J447-10J439-14:Brush Blk
10"

- J447-13:Brush Blk 13"
- J447-14WD: Brush Blk 13"
- J447-17WD: Brush Blk 13"
- J439-19: Brush Blk 13"



J447-14WHI:
Brush WHITE 14"



J447-13BR:
Brush Brown 13"



J447-18: Brush Green 15"



J447-5.5: Hand Tools Brush
White 5.5"



Rotary Brush

Brush Metal Block – Black/White

- | | |
|---|--------------|
| A. 10" Carpet Brush 0.020"/0.025" 3"CH | J447-10.5 |
| B. 10" Carpet Brush 0.020"/0.025" 3"CH | J447-14Metal |
| C. 10" Carpet Brush 0.020"/0.025" 3"CH Clutch | J447-14M2 |

Clutch Plate Metal

- | | |
|------------------------------------|------------|
| D. Clutch Plate 'A' 5" #83 | J452A |
| E. Clutch Plate 'B' 5" #92 | J452B |
| F. Clutch Plate 'C' 5" #47 | J452C |
| G. Clutch Plate 'D' 5" #46 | J452D |
| H. Clutch Plate 'D' 5" #46 style 2 | J452DM |
| I. Clutch Plate CH 3-3/8" | J452-338 |
| J. Clutch Plate 4" | J452-4CH |
| K. Clutch Plate 4190C | J452-4190C |
| L. Clutch Plate Pullman/Holt | J452-PH |
| M. | |



J447-10.5J439-14:Brush Metal 10"

J447-13:Brush Metal 14"

J447-14M2: Brush Clutch 14"



J452-PH:Pullman/Holt Clutch



J452A J452B
J452C J452D



J452DM:
D Clutch Diff Syle"
J452-338: Clutch CH3-3/8"



J452-4CH: Clutch CH4"



J452-4190C: Clutch 4190C



V Bathroom Supplies

GOJO Soap & Dispenser

Soap & Dispenser 1.25L

J. GOJO FMX Foam Dispenser Black	J286BLA
K. GOJO FMX Foam Dispenser Gray	J286GRA
L. GOJO FMX Foam Cranberry Refill	GOJ5161-03
M. GOJO FMX Foam Fruit Refill	GOJ5162-03

Soap & Dispenser 1.2L

N. GOJO TFX Soap Dispenser Gray	GOJ 2740
O. GOJO TFX Soap Refill unscent	GOJ 5665
P. GOJO TFX Soap Refill Skin Conditioner Purple	JL109
Q. GOJO TFX Soap Refill Fruit	GOJ5362
R. GOJO TFX Soap Refill Purell	GOJ5491



J286BLAJ439-14:FMX
Dispenser BLK
J286GRA:
FMX Dispenser Gray



GOJ 2740: TFX Dispenser



GOJ5362: Fruite TFX Refill



GOJ5161-03: Cranberry Refill
GOJ5162-03: Fruit Refill



GOJ 5665: unscent TFX Refill
JL109: Skin Cond. TFX Refill



GOJ5491:Purell TFX Refill

Phone 714 531 3570

Email: orangecoastchem@gmail.com



Bathroom Supplies

GOJO Soap & Dispenser

Soap & Dispenser 2L

- | | |
|--------------------------------|----------|
| A. GOJO TDX Pro Dispenser Gray | GOJ7200 |
| B. GOJO TDX Supro Max Refill | GOJO7272 |
| C. GOJO TDX Pumice Refill | GOJO7255 |

Soap & Dispenser 800mL

- | | | |
|--------------------------------|--------|----------|
| D. GOJO 800mL Dispenser Gray | | J1200BEI |
| E. Hand Soap Ultimate Refill | 12/box | JL32 |
| F. Hand Soap Derma Brand | 12/box | JL33 |
| G. Hand Soap Kimber Pink | 12/box | KCC91220 |
| H. Hand Soap KCC Skin Cleanser | 12/box | KCC91547 |
| I. Hand Soap KCC Lotion | 12/box | KCC91211 |



GOJ7200: TDX Dispenser



J1200BEI:800mL Dispenser



KCC91220:
Kimberly Clark Refill 800mL



GOJO7272: TDX Supro Refill
GOJO7255: TDX Pumice Refill



JL32: Ultimate 800mL Refill
JL33: Derma Brands 800mL



KCC91547:
KCC SkinCleaner Refill
KCC91211: KCC Lotion Refill



VI Sign Floor Sign

Floor Board

- | | | |
|----------------------|-----------|------|
| A. Wet Floor 2 sided | Bilingual | S708 |
| B. Closed 2 sided | Bilingual | S736 |
| C. Wet Carpet | Bilingual | S791 |

Floor Cone

- | | |
|--------------------------|------|
| D. Wet Floor Tall Cone | S710 |
| E. Orange Wet Floor Cone | S709 |



S708: Wet Floor Board



S791: Wet Carpet Board



S709:
Tall Yellow Cone Wet Floor



S736: Closed Board



S710: Wet Floor Orange Cone



Sign

3" X 9" Sign

Office

- A. Manager S701
- B. Employee Only S748
- C. Fire Extinguisher S754
- D. Employees must wash hand.... return to work S756
- E. No Smoking S758
- F. No Smoking Except in Designated Areas S746

Bathroom

- G. Men S771
- H. Women S770



S701: Manager



S756: Must Wash Hands...

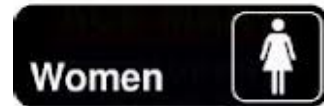

JL33: Women's Room



S748: Employees Only



S758: No Smoking



S746: No Smoking.. Designated Ares.(Brown)

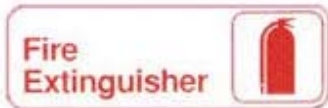

S754: Fire Extinguisher



S771: Men's Room



Sign

6" X 9" Sign

Office

- A. Fire Extinguisher S705
- B. Employee Must Wash Hand....Spanish S703
- C. Employee Must Wash hand.... English S790
- D. This is your Lunch Room Help Keep it Clean S704
- E. No Smoking S775

Bathroom

- F. Men S777
- G. Women S786
- H. Restroom S787
- I. Restroom handicapped S789
- J. Accessible Blue S788



S705: Fire Extinguisher



S704:Lunch Room
S775: No Smoking



S787: Restroom
S789:Restroom Handicapped



S703: Wash Hand Spanish
S790: Wash Hand English

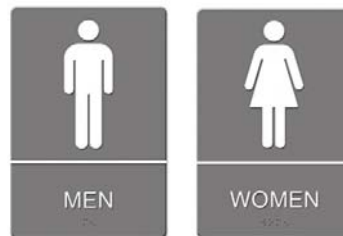

S777: Men's Room
S786: Women's Room



S788: Blue Accessible



Sign Other Sign

Office

K. In Case of Fire Do not Use Elevators Use Stair S702

Bathroom

L. Men S747
M. Women S745
N. UniSex S749



S702: In Case of Fire....



S745: Women Round



S749: UniSex Triangle in Circle Handicapped



S747: Men Triangle



VII Floor Squeegee Straight Curved Blade

Standard

A. 18" Straight	J614H
B. 24" Straight	J615H
C. 30" Straight	J616H
D. 36" Straight	J618H
E. 18" Refill Blade	J624
F. 24" Refill Blade	J625
G. 30" Refill Blade	J626
H. 36" Refill Blade	J627

Curved

I. 18" Curved Head	J621-18
J. 24" Curved Head	J621-24
K. 30" Curved Head	J621-30
L. 36" Curved Head	J621-36
M. 36" Curved Ettore	J620H

Moss

N. 22" Moss Head	J672
------------------	------



J614H:	18" Straight
J615H:	22" Straight
J616H:	30" Straight
J618H:	36" Straight
J672:	22" Moss
J624:	18" Blade
J625:	22" Blade
J626:	30" Blade
J627:	36" Blade



J621-18:	18" Curved
J621-24:	24" Curved
J621-30:	30" Curved
J621-36:	36" Curved



J620H:36" Curved Ettore



VIII Bobrick Soap System

B155

- | | |
|--|------|
| A. Soap Dispenser B155 | B155 |
| B. Soap Dispenser Bracket only B155 | P531 |
| C. Soap Dispenser Bottle only 24oz | P521 |
| D. Valve only – Corrosive Resistance Valve | P527 |

B156

- | | |
|---------------------------|------|
| E. Soap Dispenser B156 | B156 |
| F. Valve only | P525 |
| G. Retainer Collar Chrome | P550 |

Valve

- | | |
|---|------|
| H. Dispenser Powdered Valve 171-10 | P552 |
| I. Universal Soap Valve Liquid Wall Mount B2111 | P529 |
| J. O Ring- Universal Soap Valve | P548 |



B155: Soap Dispenser
P531: Bracket only B155



B156: Soap Dispenser
P525: Standard Valve

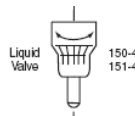

P521: 24oz Bottle B155
P527: Corrosive Resistance Valve



P550: Retainer Collar Chrome
P552: Powdered Valve 170-10



Bobrick B-2112 Parts Diagram

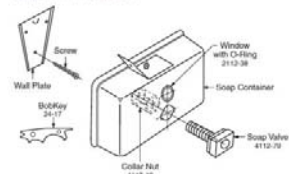

REPLACEMENT PARTS LIST	
Part Name	Part No.
Valve Replacement Kit	4112-79
Collar Nut for Valve	4112-19
Window with O-Ring	2112-38
BobKey	24-17

P529: Uni Soap Valve Wall
P548: O-Ring for B2111



Bobrick Soap System

Bobrick 8221

- K. Soap Dispenser Bottles only 8221-95 20oz P523
- L. Soap Dispenser Bottles only 8221-95 34oz P547
- M. Universal Mounting Group B822-102 P564
- N. Universal Mounting Group B8221-202 (shorter) P564-2
- O. Bottle Cap B822-94 P545
- P. Cylinder for B-822 P546
- Q. Retainer Ring B822-17 P555
- R. Felt Washer for B822 P556
- S. Supply Tube 14" 822-110 P560

B4112

- T. Valve Assembly Contura 4112-79 P1501
- U. Collar Nut 4112-19 P566



P523: 20oz Bottle only
P547: 34 oz Bottle only

Error! Reference source not found:
Mounting 822-102
P564-2: Mouting 8221-202



P545: Bottle Cap B822
P546: Cylinder B822

P556: Felt Washer 822



P560: Supply Tube B822



P1501: Valve 4112
P566: Collar Nut 4112



P555: Retainer Ring

Bobrick B-2112 Parts Diagram

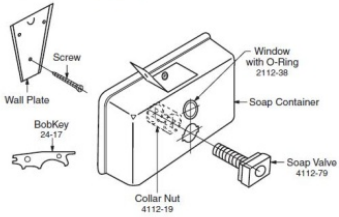

REPLACEMENT PARTS LIST

Part Name	Part No.
Valve Replacement Kit	4112-79
Collar Nut for Valve	4112-19
Window with O-Ring	2112-38
BobKey	24-17



Bobrick Soap System

Classic

V. Soap Dispenser Long Cylinder Complete
W.LD500 Soap Dispenser Bracket only

J296BEI
P539

Parts

X. Lock & Key B36203
Y. Bobrick Lock Cover
Z. Collar Nut 310-19

P544
P557
P566-1



B155: Soap Dispenser
Complete Cylinder



P539: Bracket only LD500



P557: Lock Cover



P544: Lock & Key B36203



P566-1: Collar Nut 310-19



IX TruckMount Parts

Special

- A. Pressure Regulator Valve MV 580 P978
- B. Forever Clean Magnet – Water conditioner E606

Filter

- C. Inline VAC Filter Sock Only P1856
- D. Inline VAC Hose Stainless Steel Filter Only P1132
- E. Inline VAC HOSE Filter C1696
- F. Filter Bag Cloth 8" X 29" P902
- G. Filter Bag Cloth 12" X 19" P903
- H. Filter Bag Cloth 8" X 7" P904



P978: Pressure Regulator
MV580



P1856: Inline Filter Sock



P902: Filter bag Cloth 8" X29"
P903: Filter bag Cloth 12" X19"
P904: Filter bag Cloth 8" X7"



P1132: Inline Filter S/S



E606: Clean Magnet



C1696: inline Hose Filter



X Repair Parts Floor Machine / Vac

MasterCraft

- A. Toggle Switch E14 only P331
- B. Toggle Switch Kits P332
- C. Switch Lever and Spring Assembly 386839 P333
- D. Switch Lever only P333a
- E. Handle Clamp Lever 380520 P351
- F. Squeege Blade Wet/Dry Vac 14" 448257 P352
- G. Lock Lever Hold Down Clamp Wet/Dry Vac P335

Pullman Holt

- H. Switch 2609-1150 P1240

Hoover

- I. Spacer Rear Wheel 31148004 P1458



P331: Switch E14
P332: Switch Kits

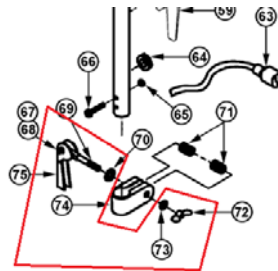

P351: Handle Clamp Lever



P352: Squeege Blade



C1696: Lock Lever Hold Down Clamp Wet/Dry Vac

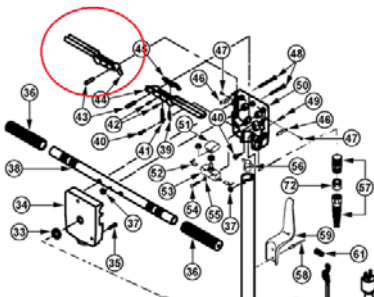

P333: Switch Lever and Spring Assembly
P333a: Switch Lever only

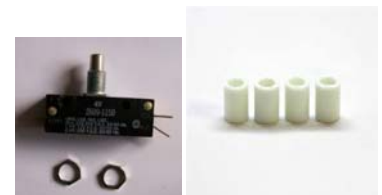

P1240: Switch Pullman/Holt
P1458: Hoover Spacer Rear Wheel.

Phone 714 531 3570

Email: orangecoastchem@gmail.com



Repair Parts

Floor Machine / Motor

Mercury

- | | |
|---------------------------|------|
| A. Switch G-30-AB | P462 |
| B. Switch Lever A105 | P463 |
| C. Handle Clamp CCA | P464 |
| D. Cord Strain Relief G66 | P465 |

Ametek Motor Parts

- | | |
|-------------------------------------|---------|
| E. Cooling Fan Vac 7.2" | P621910 |
| F. Cooling Fan Vac 5.7" | P621906 |
| G. Ametek Felt Washer | P21997 |
| H. Ametek Motor Armature 05-8135-06 | P8135 |
| I. Ametek Carbon Brush 33410 | P33410 |
| J. Ametek Carbon Brush 116103 | P116103 |



P462: Switch G-30-AB
P463: Switch Lever



P465: Cord Strain Relief



P8135: Ametek Armature

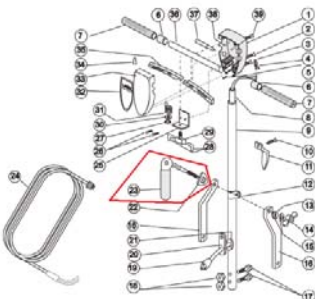

P464: Handle Clamp



P621910: 7.2" Cooling Fan Motor
P621906: 5.7" Cooling Fan Motor



P33410: Carbon Brush 33410
P116103: Carbon Brush 116103



P21997: Ametek Felt Washer



Repair Parts Bearing

Bearing

- | | |
|---|--------|
| A. Hoover Bearing Brush Roller 4367002 pair | P21860 |
| B. Bearing GBC 38-RS OD:19mm, ID:6mm W: 6mm | P21862 |
| C. Bearing NSK 626Z OD:19mm, ID:6mm W: 6mm | P21863 |
| D. Bearing NSK 608Z OD:22mm, ID:8mm W: 7mm | P21865 |
| E. Bearing NSK 608V OD:19mm, ID:8mm W: 7mm | P21999 |

Ametek Motor

- | | |
|---|--------|
| F. VAC Motor 2 Stage 11660033-B/C | P21872 |
| G. VAC Motor 2 Stage 116392 | P21979 |
| H. VAC Motor 2 Stage TMI | P7501 |
| I. VAC Motor 2 Stage 119414 | P1194 |
| J. VAC Motor 2 Stage 116765 w/o attachement | P21982 |
| K. VAC Motor 116311 | PL1163 |



P21860: Hoover Brush Bearing



P21862: GBC 38-RS



P21863: NSK 626Z

P21865: NSK 608Z



P21999: NSK 608V



P21872: Motor 11660033



P21979: Motor 116392



P7501: TMI 2stage Motor
P1194: Motor 119414



P21982: Motor 116765
PL1163: Motor 116311

Phone 714 531 3570

Email: orangecoastchem@gmail.com



Repair Parts Sprayer

Solo

A. Pressure Valve 4800185-P	P1451
B. Shut-off Valve Repair Kit	P1452
C. Pump Repair Kit 4900405K	P1453
D. Swirl Plate 407475	P1455
E. Jet Cap Nozzle 7074758	P1456
F. Cap Gasket Tank 4061342	P1457

RL FLO Master

G. Check Valve	RCC37409
----------------	----------

B & G Sprayer

H. B & G Check Valve PV-266	P402
I. Polypropylene Plunger Cup NP277	P406
J. Gasket 2" ID Flat	P411a
K. Gasket 2-3/8" ID Round	P411b
L. Gasket 1-7/8" ID Flat	P411c



P21860: Pressure Valve



P1452: Shut-off Valve Kit



P1453: Pump Repair Kit

P1455: Swirl Plate



P1456: Jet Cap
P1457: Cap Gasket



RCC37409: Check Valve FLO Master
P402: Check Valve B&G



P406: Poly Plunger Cup

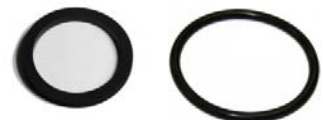

P411a: Gasket Flat 2"
P411b: Gasket Round 2-3/8"
P411c: Gasket Flat 1-7/8"

Phone 714 531 3570

Email: orangeoastchem@gmail.com



Repair Parts Sprayer

B & G Sprayer

- M. Tank Sprayers Gasket Kit 33000253
- N. Nozzle Assembly style 1 4300237
- O. Nozzle Assembly style 2 4300237
- P. Shut off Lever
- Q. Pump Barrell SSS2
- R. Nozzle Fan Spray tip 800067 & cap TC52
- S. QT-1 1.5 Quart Nozzle 17017316
- T. B & G misc parts

- P420
- P421a
- P421b
- P431
- P440
- P448
- PQT1A
- PBGmisc

Impact Sprayer

- U. Handheld Sprayer Handheld ½ gal
- V. Tank Sprayer Spare Kits CZ9905FPM

- E621
- E621P



P420: Tank Gasket Kit



P431: Shut off Lever
P440: Pump Barrell



E621: HandHeld Sprayer ½ gal



P421a: Nozzle
P421b: Nozzle



P448: Nozzle Fan Spray Tip & cap



PQT1A: QT1A parts.



E621P: handheld sprayer
spare kits CA9905FPM



Repair Parts

PMF Part

Ball Valve

A. Ball Valve Small 1/4" FPT MPT	H49	P21912
B. Ball Valve Small 1/4" FPT MPT	Econ	P21912Econ

Inline Filter

A. Inline Filter 1/4"	H58	P1974
B. Inline Filter 1/4" w/Check Valve	H59	P1961
C. Inline Filter Insert 1/4" vee jet strainer	H44	P1916
D. Inline Filter Insert w/Check Valve	H45	P1967
E. Inline Filter Insert 1/8" vee jet strainer	H43	P988

Jet Flood

F. Jet Special Flood 1/8"	H56	P621131
G. Jet Tee Plastic & S/S 11003	H53-11003	P1935
H. Jet Tee Plastic & S/S 8001	H53-8001	P21110
I. Jet Tee Plastic & S/S 8003	H53-8003	P21113



P21912: Ball Valve 1/4"



P21912Econ: Ball Valve



P1974: Inline Filter 1/4"

P1961:
Inline Filter 1/4" w/ Check Valve



P1916: 1/4" Vee Jet strainer

P1967:
1/4" Vee Jet Strainer w/check Valve



P988: 1/8" Vee Jet strainer



P621131:
Jee Special Flood 1/8" H56



P1935: JeeTee Plastic 11003

P21110: Jee-T Plastic 8001

P21113: Jee-T Plastic 8003



Repair Parts

PMF Part

Quick Coupler Hose Sleeve

J. Quick Coupler Hose Sleeve Female	1/4"	P21914F
K. Quick Coupler Hose Sleeve male	1/4"	P21914M

Squeegee Blade & Brush

L. Squeegee Blade	Blade-904	P1931
M. Brush Strip	Brush-904	P1932

Trigger Handle, Valve Holder

N. Trigger Handle	AC29	P1914
O. Valve Handle	AC61A	P964
P. Valve Handle V800 V500	AC34800WA	P1915H
Q. Valve Hanger ParaPlate	AC42	P1980
R. Valve Hanger Stair Tools	AC31H	P1834
S. Valve Hanger Detailer Tools	AC31V5	P910
T. Valve Holder Bracket 2"	AC30	P1984
U. Valve Holder Bracket 1.5"	AC31	P1986



P21914F: Hose Sleeve 1/4" F
P21914M: Hose Sleeve 1/4" M



P1931: Blade-904
P1932: Brush-904



P1914: Trigger Handle AC29



P964: Valve handle AC61A



P1915H: Handle V800 V500



P1980: Valve Hange Para Plate



P1834: Valve Hanger Stair Tool



P910: Valve Hanger Detailer



P1984: Valve Holder 2"
P1986: valve Holder 1.5"



Repair Parts

PMF Part

Valve

V. Valve Paraplate 800psi	AC41	P1978
W. Valve 300psi 1/4" FPT	V300	P1977
X. Valve 500psi Brass	V2P-EZ	P1915
Y. Valve 800psi 1/4" FPT	V800	P1976

Valve Lever

Z. Valve Lever 120psi Valve	AC34800HT	P1954
AA. Valve Lever Paraplate	AC34	P1982
BB. Valve lever Paraplate Reinforced	AC35	P1909

Valve Rebuild Kit

CC. Valve R/B kit 500psi	RV2P	P21910
DD. Valve R/B kit Paraplate	RAC41	P1996
EE. Valve R/B kit R550	R550	P1990MISC

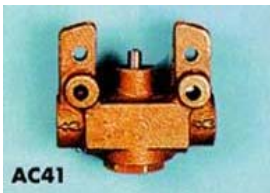

AC41

P1978: Ball Para 800psi

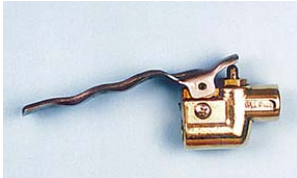

P1977: Valve 300psi



P1915: Valve 500psi



P1976: Valve 800psi



P1954: 120psi Valve Lever



P1982: Valve Lever paraplate



P1909: Reinforce Valve Lever



P21910:
R/B kit 500 psi RV2P



P1996: R/B kit RAC41



P1990MISC:
R/B kit R550

Repair Parts

PMF Part

Wand Grip

FF.	Wand Grip 1.25"	AC14	P621129
GG.	Wand Grip 1.5"	AC13	P621130

Wand Sleeve

HH.	Wand Sleeve Vinyl Slip-on 1.5"	AC15	P21906
II.	Wand Sleeve Vinyl Slip-on 2"	AC17	P1988

Wand Slide

JJ.	Wand Slide 12" Stainless Steel	AC33-12	P21111-12
KK.	Wand Slide 14" S/S	AC33-14	P21111
LL.	Wand Slide 16" S/S	AC33-16	P21190

Vac Hose

MM.	Vac Hose Blue 1.5" X 25" with Cuff	C681FBLU-25
-----	------------------------------------	-------------



P621129: Wand Grip 1.25"
P621130: Wand Grip 1.5"



P21111-12: 12" Wand Slide
P21111: 14" Wand Slide
P21190: 16" Wand Slide

P1954: 120psi Valve Lever
P1982: Valve Lever paraplate
P1909: Reinforce Valve Lever
P21910:
R/B kit 500 psi RV2P
P1996: R/B kit RAC41



P21906: Wand Slip 1.5"
P1988: Wand Slip 2"



P1976: 25' Vac Hose

Phone 714 531 3570

Email: orangecoastchem@gmail.com



XI Equipments Add-on

Heater

- A. Bucket Heater 1000W E114
- B. Bucket Heater 1150W E1636

Hose Adapter Stainless Steel

- C. Hose Connector VAC Attack S/S 2" to 1.5" P1866
- D. Hose Connect 2" to 1-3/4" S/S P944Special
- E. VAC HOSE 2"- Tools 1-1/4" Adapter S/S AC24 P940
- F. Hose Connect VAC Release 1.5" S/S P958

Hose Adapter

- G. Hose Cuff 2" hose to 2" tools P21967GRA
- H. Hose Cuff 2" Swivel (Big Ended Threaded) P21941GRA
- I. Hose Connector 2" to 2" P21973GRA
- J. Hose Cuff 1.5" hose to 2" tools P21971GRA
- K. Hose Cuff 2" hose to 1.5" tools P21969GRA



P978: Bucket Heater 1000W
E1636: Disc Heater 1150W



P1132: Inline Filter S/S
C1696: inline Hose Filter



P21973GRA: 2" Conn



P1866: Inline Filter Sock
P944Special:
2"- 1.75" Hose Conn.



P21967GRA: 2" Hose/ 2"tools



P21971GRA: 1.5"Hose/2"Tools
P21969GRA: 2"Hose/1.5"Tools



P21941GRA: 2" Swivel

Phone 714 531 3570

Email: orangecoastchem@gmail.com



Equipments

Add-on

Hose Adapter

L. Hose Cuff 1.5" hose to 1.5" tools	P21966
M. Hose Cuff 1.5" hose to 1.5" tools Swivel	P21966S
N. Hose Connector 1.5" to 1.5"	P21968
O. Hose Cuff 1.25" hose to 1.5" tools	P21991
P. Hose Connect 1.5" to 2" Hard Plastic	P951
Q. Hose Connect 2" to 2" Hard Plastic	P21974
R. Hose Connect 1.5" to 1.5" Hard Plastic	P21975
S. Hose Cuff 1.5" hide-a-hose	P963
T. Hose Cuff 1.5" hide-a-hose Adapter	P9633



P21966: Hose Cuff 1.5"



P21991:
Hose 1.25"/Tools 1.5"



P963: 2" Hide-A-Hose 1.5"



P21966S:
Hose Cuff 1.5" Swivel



P951: Hose 1.5" to 2"



P9633:
1.5" Hide-A-Hose Adapter



P21968: Hose Conn 1.5"



P21974: Hose Conn 2" - 2"
P21975: Hose Conn 1.5" - 1.5"



Equipments Cleaning Helper/Tools

Tools/Helper

A. Door Stop Wedge	J123
B. Rocket Scraper	J124
C. Putty Knife Gum Scraper	J253
D. EZ Reacher replacement Cups	J258
E. EZ Reacher 32"	J257
F. Unger Nifty Nabber Suction Cup	P512
G. Hose Tie EZ wrap 10"	C674
H. Hose Strap VAC Hose	C661
I. Handy Spotting Tools	C669
J. T-Bone Spotting Tools	C685
K. Measured Dual Twin Wheel	E1638



J123: Door Stop Wedge



J258:
EZ Reacher replacement Cups
J257: EZ Reacher 32"



C661

C669: Handy Spotting Tool



J124: Rocket Scraper



P512:
Unger Nifty Nabber cup



C685: T-Bone Spotting Tool



J253: Putty Knife Gum Scraper



C674: Hose Tie EZ wrap 10"
C661: Hose Strap VAC Hose



E1638: Measure Twin Wheel

Phone 714 531 3570

Email: orangecoastchem@gmail.com



Equipments Tools / Bottle Cap

Tools/Helper

L. Can Crusher

J95678

M. Cement All 10lb

J10110

Bottle Cap

N. Mixing Bottle Spigot

J1226

O. Measured Cup 8oz

J275

P. Measured Cup 8oz

J275-1oz

Q. Bottle Cap Safety

Jcap1

R. Bottle Cap Safety thin

Jcap2

S. Bottle Cap Safety Poly

Jcap3

T. Bottle Cap Safety Polyseal Black

Jcap4

U. HydroForce Bottle 5qt

P1491

V. Mixing Bottle 2.5gal with Spigot

J260



J95678: Can Crusher



J275: Measured Cup 8oz
J275-1oz: Measured Cup 1oz



P1491: 5qt Bottle



J10110: Cement 10lb



Jcap1: Safety Cap
Jcap2: Thin Safety Cap



J260: 5 Gal Mix Bottle Spigot



J1226: Bottle Spigot



Jcap3: Safety Cap Poly
Jcap4: Safety Cap Polyseal Blk

Phone 714 531 3570

Email: orangecoastchem@gmail.com



Equipments

Carpet Repair Tools

Carpet Repair Tools

- | | | |
|----------------------------|----------|------|
| A. Nap Shear Big Loop | Crain187 | C650 |
| B. Napping Shears DuckBill | Crain190 | C631 |
| C. Stair Tool 3-1/2" | Crain152 | C632 |
| D. Stair Tool 2-7/8" | Crain154 | C633 |
| E. Stair Tool Bent" | Crain155 | C659 |
| F. RAZOR Carpet Knife | Crain720 | C640 |
| G. Seam Roller Big Foot | Crain437 | C628 |
| H. Seam Roller 3-1/2" | Crain436 | C654 |
| I. Kicker Knee | Crain505 | C627 |



C650:
Nap Shear Big Loop 187



C633:
Stair Tools 2-7/8" Crain152



C674:Seam Roller Big Foot



C631:
Napping Shear DuckBill 190



C659:
Stair Tools Bent Crain155



C654: seam Roller 3-1/2"



C632:
Stair Tools 3-1/2" Crain152



C640: Razor Carpet Knife



C627: Kicker Knee

Phone 714 531 3570

Email: orangecoastchem@gmail.com



Equipments

Carpet Repair Tools

Carpet Repair Tools

J. Cookie Cutter	Crain173	C655
K. Instant Repair Tools	Crain174	C634
L. Instant Hold patch 4-1/2"		C1658
M. Tool Pouch Leather Med	Crain354	C638
N. Tool Pouch Leather Lg	Crain407	C639
O. Injectimate		C602
P. Hypo Needle Injector		C603
Q. Glue Gun	Crain204	C635
R. Glue Stick	Crain202	C636B



C655:
Cookie Cutter 173



C638:
Tool Pouch Med Crain354



C603:Hyp Needle Injector



C634:
Instant Repair Tools 174



C639:
Tool Pouch Lg Crain407



C635: Glue Gun Crain204

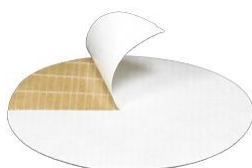

C1658:
Instant Hold Patch 4.5"



C602: Injectimate



C636B: Glue Stick Crain202



Equipments

Carpet Repair Tools

Carpet Repair Tools

S. Staples T-50 ¼"	Arrow Pack	C646P
T. Staples T-50 3/8"	Arrow Pack	C647P
U. Staples T-50 5/16"	Arrow Pack	C648P
V. Razor Blades Carpet Knives	0.017 HD	C630P
W. Skidder Furniture Movers 8"		C1656
X. Skidder Furniture Mover 4"		C1651
Y. Plier	ChannelLock526	T1701
Z. Wrench Adjustable	ChannelLock810	T1702
AA. Pry Bar Small	Crain157	T171
BB. Pry Bar Stanley 55-515		T1710
CC. Hammer Holder		T1707



C646P: Staple T-50 ¼"
C647P: Stape T-50 3/8"



C1656: Furniture Mover 8"
C1651: Furniture Mover 4"



T171: Pry Bar Small



C648P: Stape T-50 5/16"
C630P:
Razor Blade Carpet Knife



T1701: Plier 526



T1710: Pry Bar Stanley 55-515



T1702: Wrench 810



T1707: Hammer Holder