



*Creating Your  
Outdoor Lifestyle*



**Book of Design:**  
**Outdoor Kitchens**



# Space & Optimal Configuration

Outdoor kitchens have become a fixture in the backyard. When building you will want to consider the size of your patio, deck or space where the outdoor kitchen will be located? It is important to make sure the outdoor kitchen footprint is proportional to the space - providing enough room to walk around and congregate. The three most common outdoor kitchen configurations are Straight (S-Series), L-Shape (L-Series) and U-Shape (U-Series). The following Standard Layout and Options guide combines these configurations with appliance packages.

## **Straight Grill or Island (S-Series)**

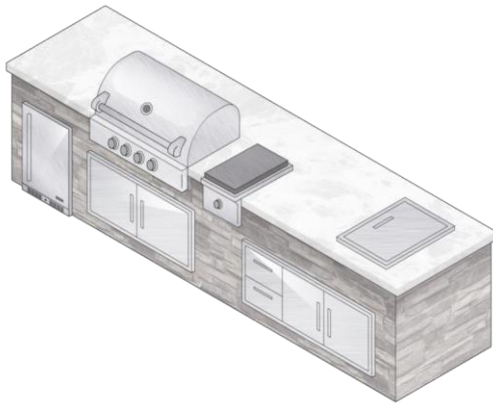

Straight outdoor grill stations or islands are perfect for small spaces. Can be built on patio perimeter or located on an existing exterior wall. Can add a detached, parallel bar or refreshment station.

## **L-Shape Bar-Island (L-Series)**

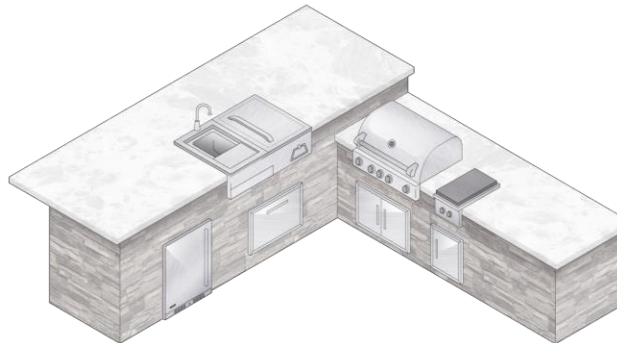

L-Shape outdoor kitchen bar-islands, similar to a Straight island can work well in small to medium size spaces and can be located on perimeter of patio. L-Shape layout are a great way to add convenient prep and bar space.

## **U-Shape Bar-Island (U-Series)**

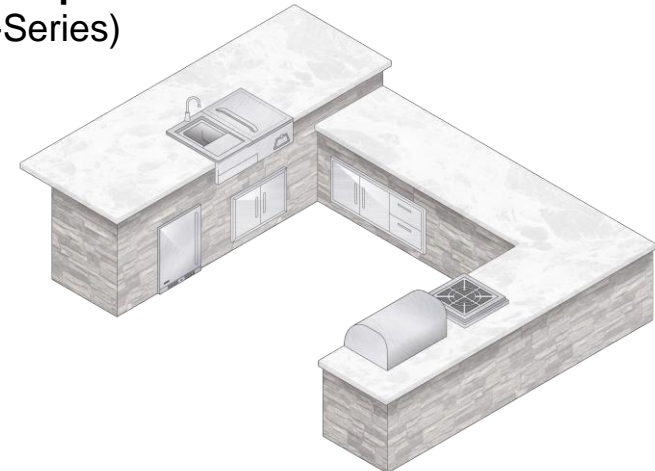

U-Shape outdoor kitchens are the ultimate in prepping, cooking and entertaining outside. A U-Shape requires a medium to large space. The U-Shape also offers convenience with all appliances, utilities and components in one place.



# 5' S-Series

The **5 ft Outdoor Grill Island Series** is the ideal solution for smaller spaces and makes the perfect grill station. The 5 ft Series can be paired with a Kamado Station and/or a separate Bar-Refreshment Station. For the budget conscience it can also be built upon at a later date.



## 5' Straight

**\$3,950.00**

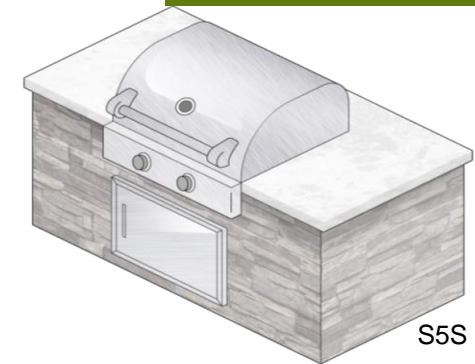

5' W x 26" D outdoor kitchen grill island with centered 28" Coyote grill and single access door.

**Appliances**  
28" C-Series  
CSA1724





# Refreshment & Cold Bar



## Refreshment Center Island



**\$4,150.00**  
+ Plumbing

### Description

5 ft Refreshment Island with Coyote refreshment center and single access door

### Components

CRC  
CSA1724



## Cold Bar Island



**\$4,300.00**  
+ Power Source

### Description

5 ft cold bar island with Coyote built in refrigerator and drop in cooler.

### Components

CDIC  
CBIR21





# 8' S-Series



The 7.5 ft **Outdoor Kitchen Island Series** provides more preparation, cooking and cabinet space. The 8 ft Series can be paired with a Kamado Station and/or a separate Bar-Refreshment Station.

## 8' Straight

**\$5,250.00**



### Description

7.8' W x 26" D outdoor kitchen island with left justified 28" Coyote grill, double access door and drop in cooler

### Appliances

28" C-Series  
CDA2431  
CDIC



# 10' S-Series

## Galley Kitchen

Building your outdoor kitchen in phases is a great way to expand your outdoor living spaces over time while staying within your budget. One popular method is adding a refreshment center or bar island running parallel with your outdoor kitchen island.

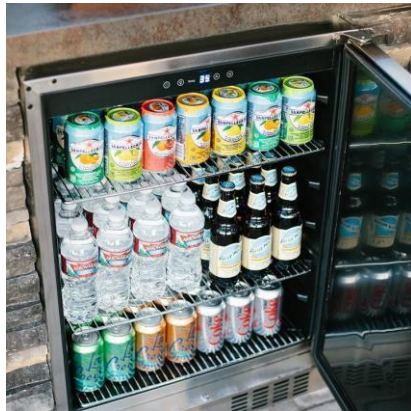
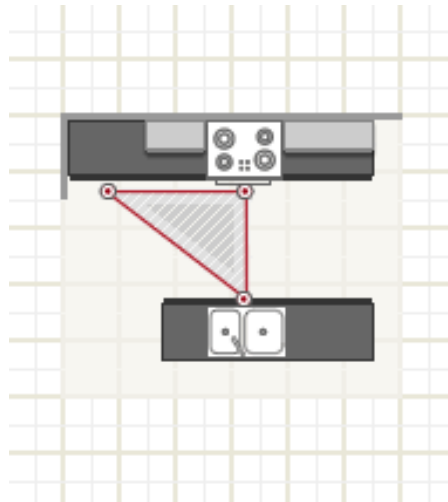

## 10' Straight

**\$7,450.00**



S10G

## Description

10 ft outdoor kitchen island with left justified 36" Coyote grill, double access doors, single side burner and drop in cooler

## Appliances

36" C-Series  
CDA2431  
CISB  
CSA2417  
CDIC





# L-Series Outdoor Kitchen



*Creating Your  
Outdoor Lifestyle*

**mgi**  
landscapes  
& outdoor living  
701-532-0212

# 15' L-Series



## 15 ft L-Shape

**\$7,480.00**

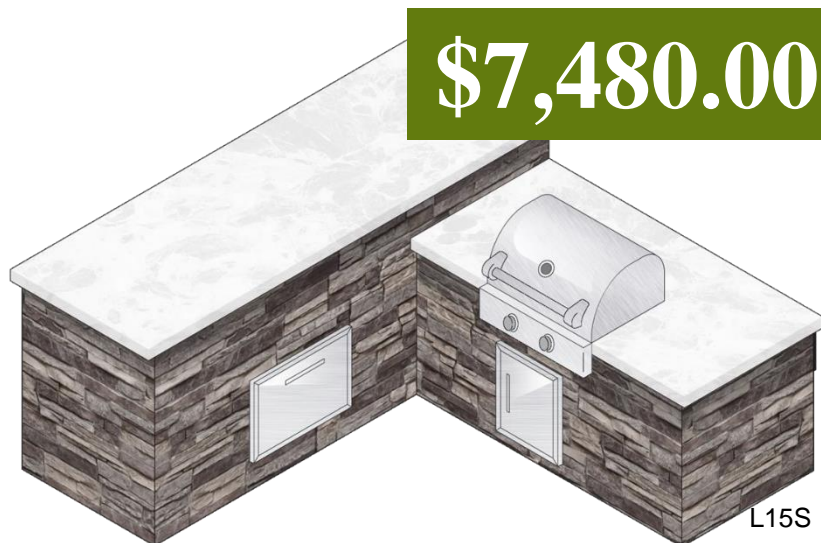

### Description

7.5 x 7.5 ft outdoor kitchen with bar and counter height and centered 28" Coyote grill, single access door and pull out ice chest

### Appliances

28" C-Series  
CSA2417  
CPOC



## 15 ft L-Shape w/Extended Bar Overhang

**\$9,680.00**

+ Power Source



### Description

7.5 x 7.5 ft outdoor kitchen with 12" counter overhang on bar and 34" Coyote grill, single side burner, double and single access doors with built in refrigerator

### Appliances

34" C-Series  
CDA2439  
CSA2417  
CBIR24  
CISB





# 20' L-Series

**COYOTE**  
Outdoor Living



20 ft L-Shape

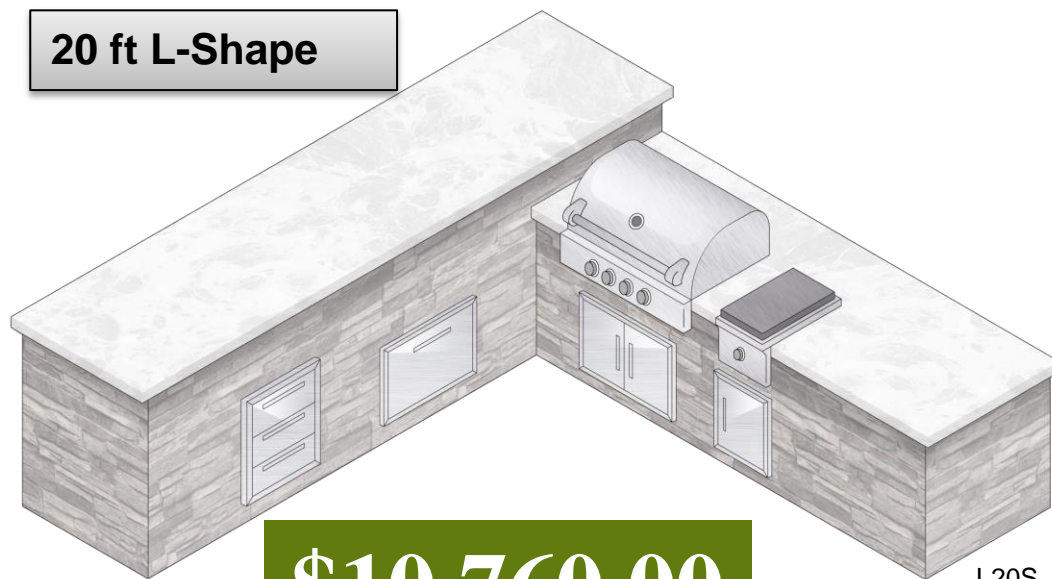

**\$10,760.00**

L20S

## Description

10 x 10 ft outdoor kitchen with bar and counter height and centered 34" Coyote grill, single burner, double and single access doors, three drawer cabinet and pull out ice chest

## Appliances

34" C-Series  
CDA2431  
CSA2417

C1SB  
CPOC  
C3DC



**mgi**  
landscapes  
& outdoor living



# U-Series Outdoor Kitchen



## U-Series Outdoor Kitchen

If your space and budget allow, the U-Series is the ideal outdoor kitchen configuration for storage, convenience and entertainment.

*Creating Your  
Outdoor Lifestyle*

**mg**i  
landscapes  
& outdoor living  
701-532-0212



# 25' U-Series



## Storage and Cabinet Space

The U-Series outdoor kitchen with ClifRock panel construction offers optimum interior space. In combination with Coyote access doors and storage drawers, you will have ample storage.

## 25 ft U-Shape

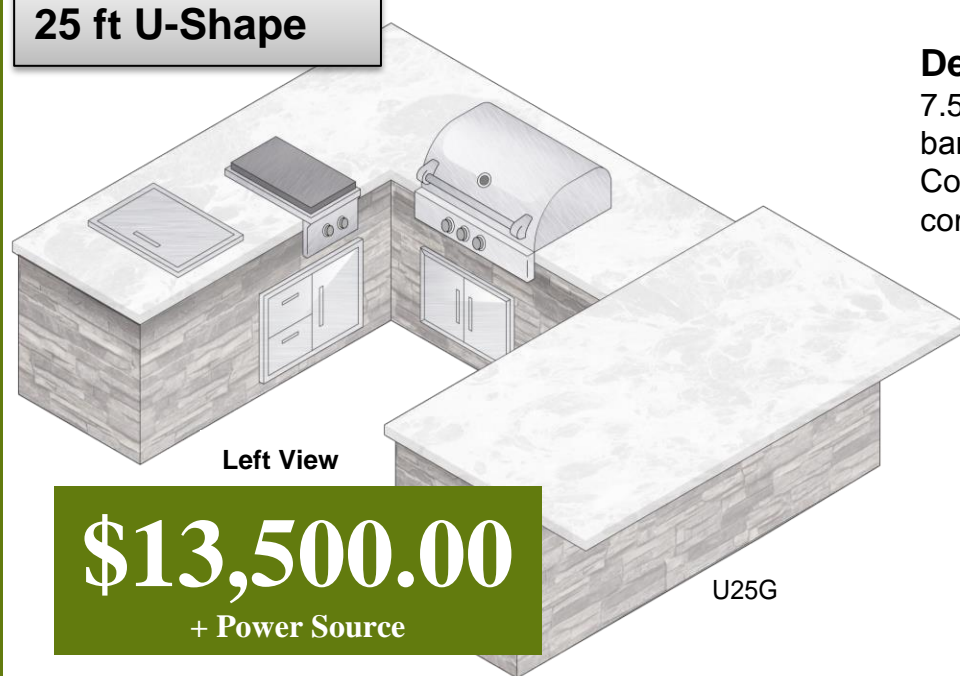

Left View

**\$13,500.00**

+ Power Source

U25G

## Description

7.5 x 10 x 7.5 ft U-Shape outdoor kitchen with bar and counter height with 12" overhang. 34" Coyote grill, single burner, double access doors, combo drawers, drop in cooler and refrigerator

## Appliances

36" C-Series  
CDA2431  
CCO-2DC31  
CIDB  
CDIC  
CBIR24

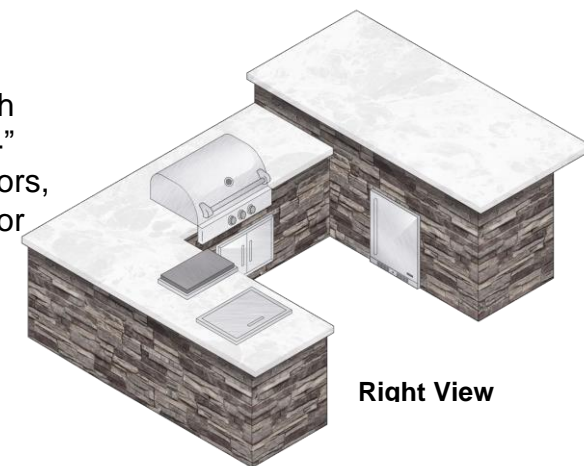

Right View

# 38' U-Series



38 ft U-Shape

**\$19,970.00**

+ Power Source  
+ Plumbing

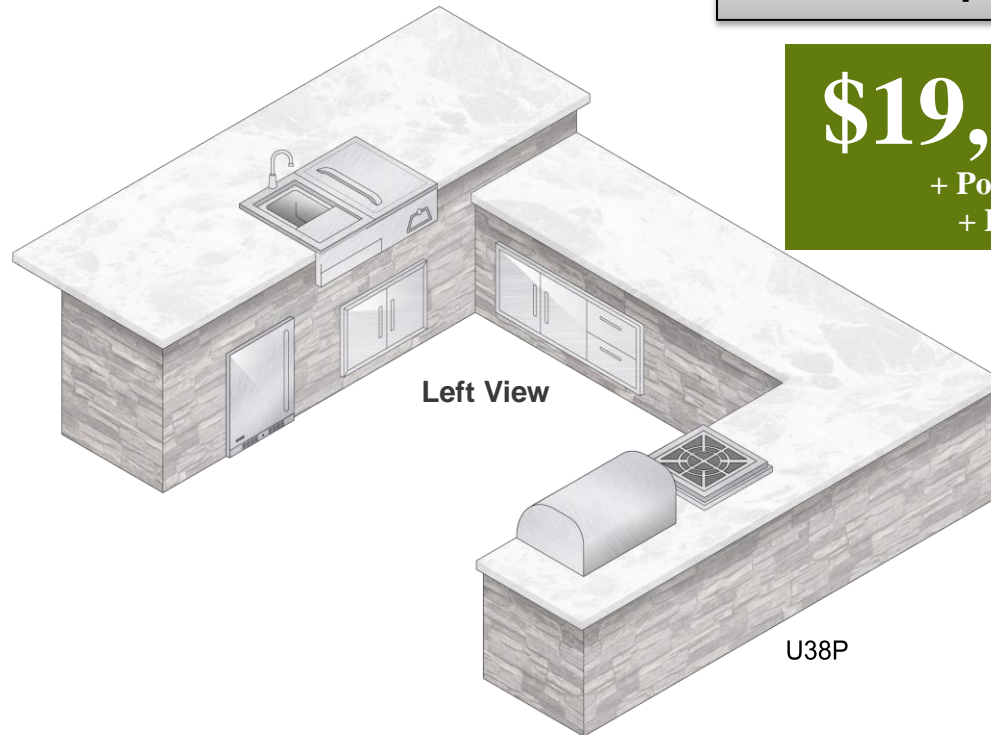

Left View

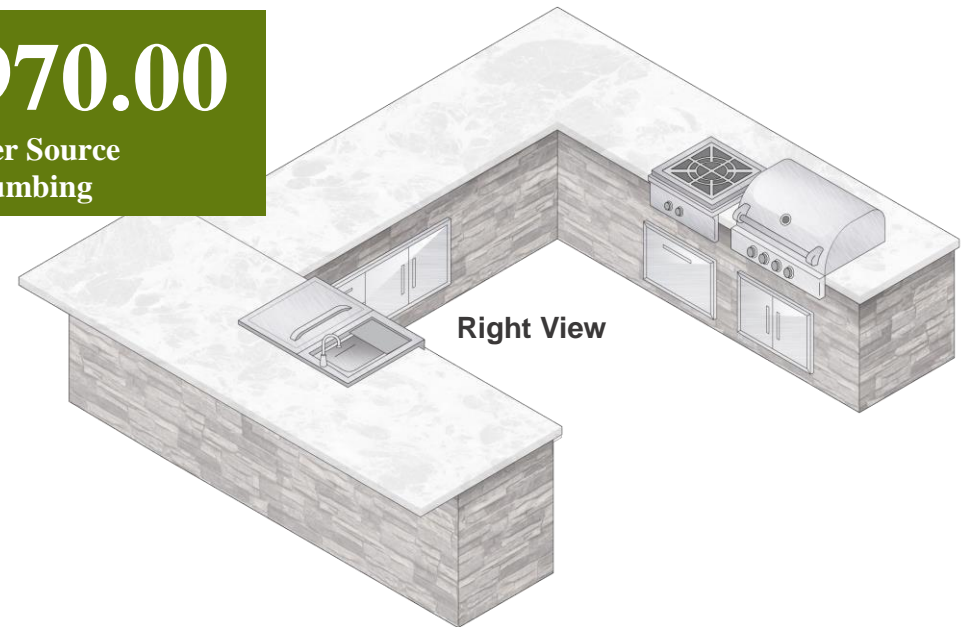

Right View

U38P

## Description

10 x 17.5 x 10 ft U-Shape outdoor kitchen with bar and counter height with 12" overhang on bar. 36" Coyote grill, power burner, (2) double access doors, combo drawers, pull out ice chest, entertainment center and 24" built in refrigerator

## Appliances

36" C-Series  
CDA2431(x2)  
C1PB  
CPOD

CCD-2DC  
CRC  
CIBR24







As Seen On

HGTV

diy  
network



4 Center St  
Merrimack, NH 03054  
(603) 792-3466



2615 E Belt Line Rd Ste 160  
Carrollton, TX 75006  
(855) 520-1559



1767 2<sup>nd</sup> Ave NW, West Fargo, ND ~ [www.mgilandsapes.com](http://www.mgilandsapes.com)

701-532-0212